

# FIRMUS B 30

⌚ indoor/ ceiling mounted

DEC 2020

## installation instructions

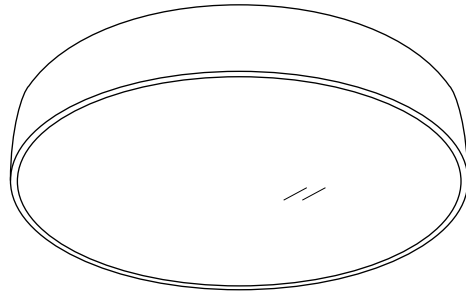

∅345

- 1** A. Make holes on ceiling.  
B. Make wiring connections.  
C. Screw the fixture on ceiling.

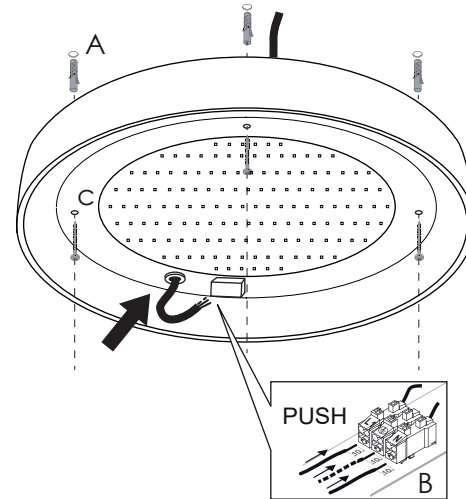
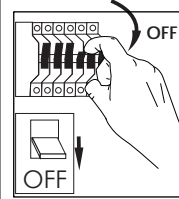

- 2** Place one side of the cover into the fixture and push the other side carefully.

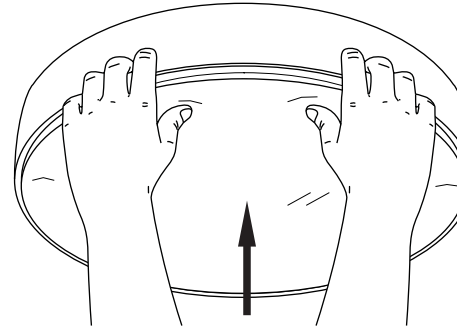

- \*** In case of maintenance:  
Push the cover up, apply the additional tool and pull it off carefully.

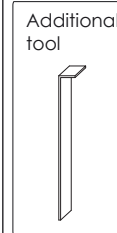
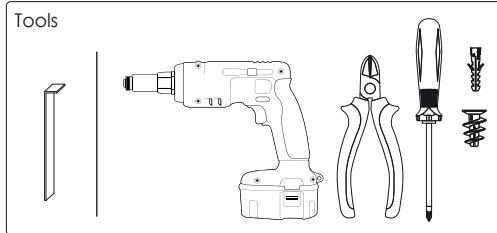
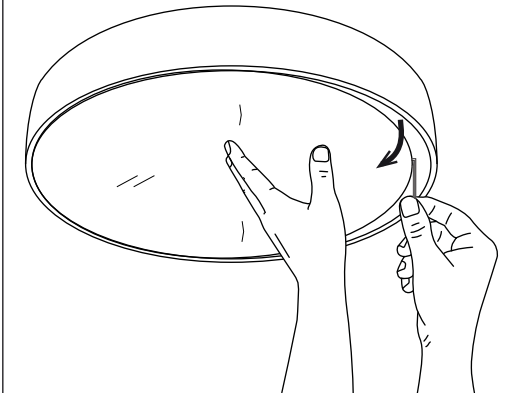

### USER INSTRUCTIONS

- The installation of the unit must be done by a qualified electrician.
- The unit must be earthed in case an earth connecting point exists.
- Ensure that the mains is switched off during servicing.
- Ensure that after the installation, the unit is properly fixed and the cable clamps (if exist) are well tightened.
- Manufacturer will not accept liability for injury or damage resulting from incorrect use or installation
- The unit is not intended to operate in loop connection.
- Wall plugs and terminals are not included.
- LED modules are replaced only by the manufacturer.

**CAUTION**  
Wear anti-static gloves before you touch LED systems

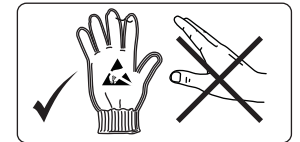

**CAUTION**  
Replace any cracked shield



**BR//GHT**  
SPECIAL LIGHTING

### Factory

5 Kefalovrisou Str., Monomati, Acharnai, P.O. Box 13677, Athens, Greece | Tel: (+30) 210 6208 230  
E-mail: info@bright.gr | www.bright.gr

IP40



CE

