

# FUGA 2 RING

indoor/ profiles

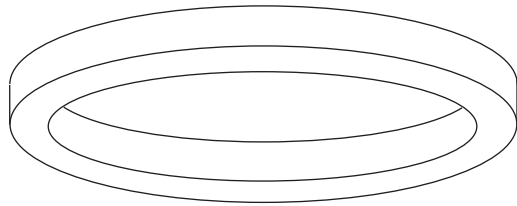

ø600 | ø800 | ø1000 | ø1200 | ø1400 | ø1600 | ø1800 | ø2000

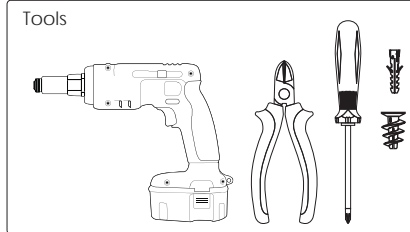
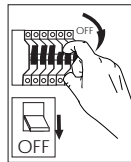

**1 Make holes.**

3 metal strips

4 metal strips

5 metal strips

**2 Screw on ceiling the metal strips.**

Ceiling

**3 Make wiring connections.**

**4 Fit the fixture on ceiling. Tighten 2 screws on each metal strip.**

**USER INSTRUCTIONS**

- The installation of the unit must be done by a qualified electrician.
- The unit must be earthed in case an earth connecting point exists.
- Ensure that the mains is switched off during servicing.
- Do not use bulb(s) bigger than the indicated on units name-plate or packaging.
- Ensure that after the installation, the unit is properly fixed and the cable clamps (if exist) are well tightened.
- Manufacturer will not accept liability for injury or damage resulting from incorrect use or installation
- The unit is not intended to operate in loop connection.
- Wall plugs and terminals are not included.
- LED modules are replaced only by the manufacturer.

**CAUTION**  
Wear anti-static gloves before you touch LED systems.

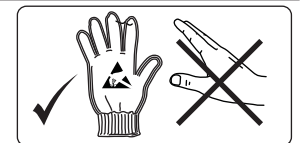

**CAUTION**  
Replace any cracked shield.

