

FUGA 2 SQUARE TRIMLESS A

indoor/ profiles

installation instructions



1 Installation

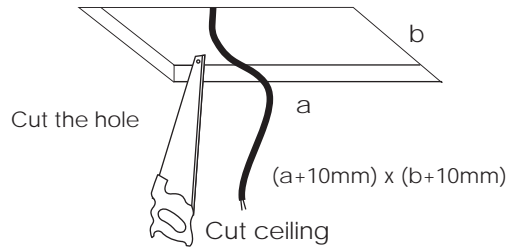

2 Finish or/and paint the edge of the false ceiling for a better installation result.

! CAUTION
Make sure you keep the hole dimensions

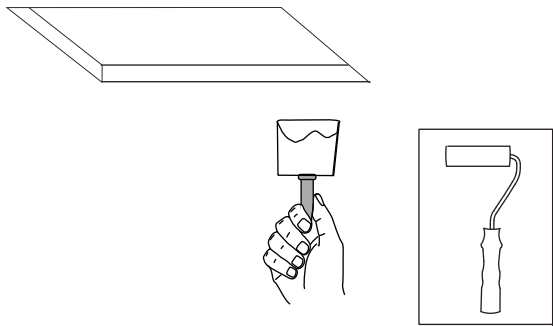

3

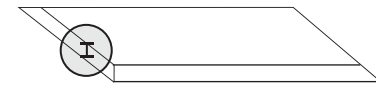

Measure the width of false ceiling and screw the metal strips
Screw on the fixture all the restraint metal strips

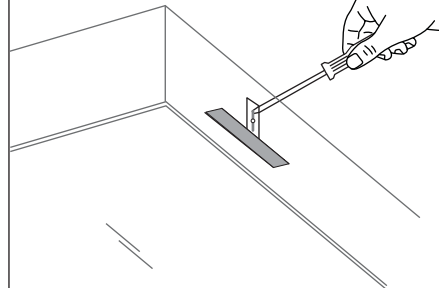

Adjust the position of the strip according to this width

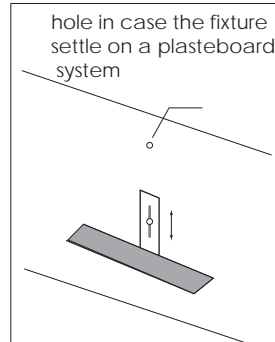

4

Make wiring connections

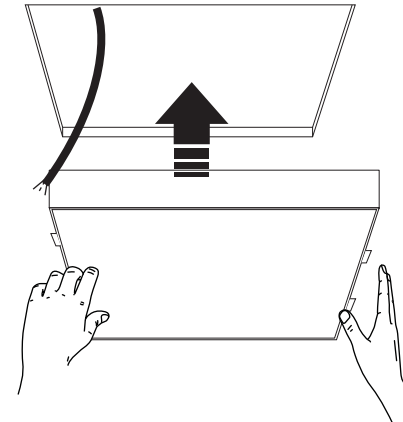
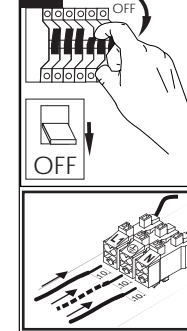

5

Fit into the false ceiling

Screw the fixture on ceiling, grout and paint

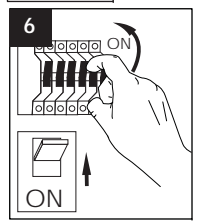
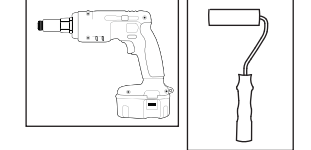
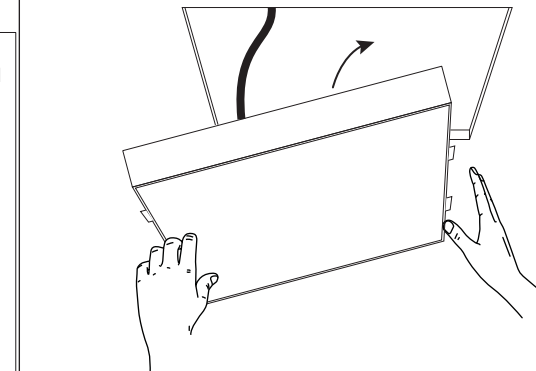

USER INSTRUCTIONS

- The installation of the unit must be done by a qualified electrician.
- The unit must be earthed in case an earth connecting point exists.
- Ensure that the mains is switched off during servicing.
- Do not use bulb(s) bigger than the indicated on units name-plate or packaging.
- Ensure that after the installation, the unit is properly fixed and the cable clamps (if exist) are well tightened.
- Manufacturer will not accept liability for injury or damage resulting from incorrect use or installation
- The unit is not intended to operate in loop connection.
- Wall plugs and terminals are not included.
- LED modules are replaced only by the manufacturer.

CAUTION
Wear anti-static gloves before you touch LED systems

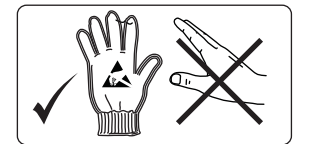

CAUTION
Replace any cracked shield

